

$F_{max} = 1500 \text{ N}$

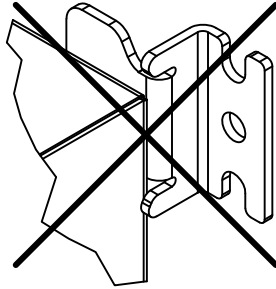

Für dynamische Belastung:  
For dynamic loads:  
Pour des charges dynamiques:  
Voor dynamische belastingen:  
För dynamiska belastningar:  
Per carichi dinamici:  
Para cargas dinámicas:

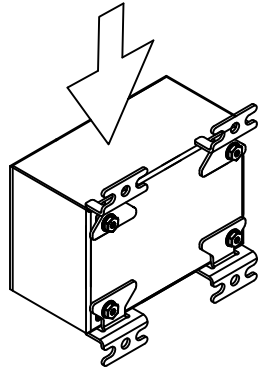
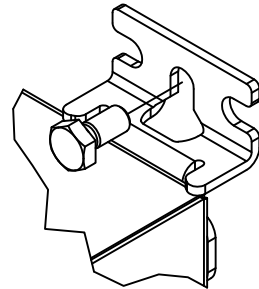

2x

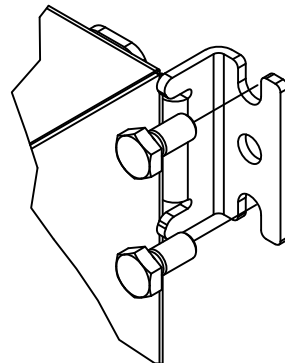

Raum für Verpackungsdatum  
Area for date of packing  
(MMJJTT / MMYDD)



[www.rittal.com](http://www.rittal.com)



ENCL. ACC.  
E491171  
Type 1, 3R, 4, 12

SZ  
2508.020

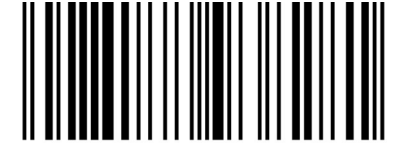

4028177938281

1x		4x		M10 x 13
1x		4x		M8 x 16
1x		4x		Ø6/18 x 2,4
1x		4x		Ø8,2/16
1x		4x		M8

Dok.-Nr. / No. of doc.: A09186606SZ  
Versandbeutel-Nr. / No. of accessory bag: -

Made in XXXXX  
Lieferanten-Nr. / No. of supplier:

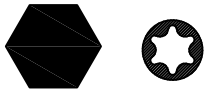

SW 13 / TX40



SW 13

### Option 1

$M_A = 13+1 \text{ Nm}$

M10 x 13

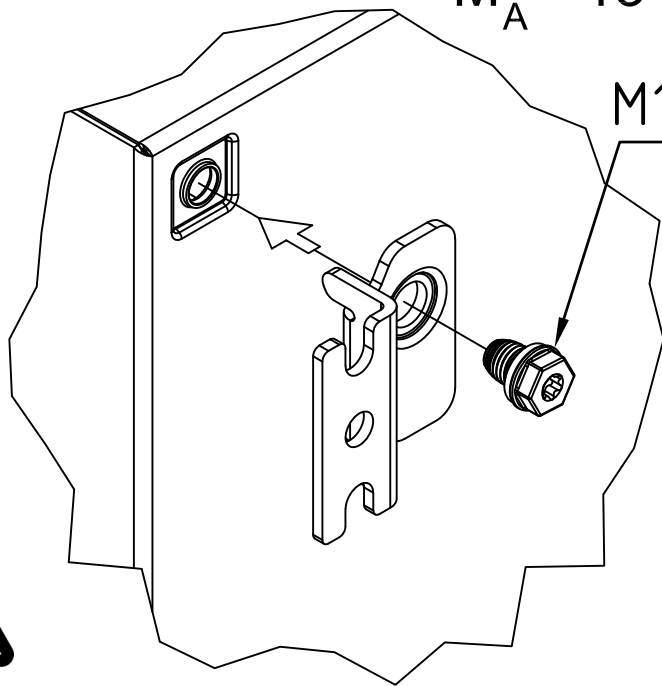

Nicht für dauerhafte/erhöhte dynamische Belastung !  
 Not to be used for permanent/increased dynamic loads!  
 Ne pas utiliser pour des charges dynamiques augmentées/permanentes!  
 Niet voor permanente/verhogende dynamische belastingen!  
 Ej för permanenta/ökande dynamiska belastningar!  
 Non idoneo per carichi dinamici continui!  
 No utilizar para cargas dinámicas permanentes/aumentadas!

### Option 2

$M_A = 13+1 \text{ Nm}$

M8 x 16

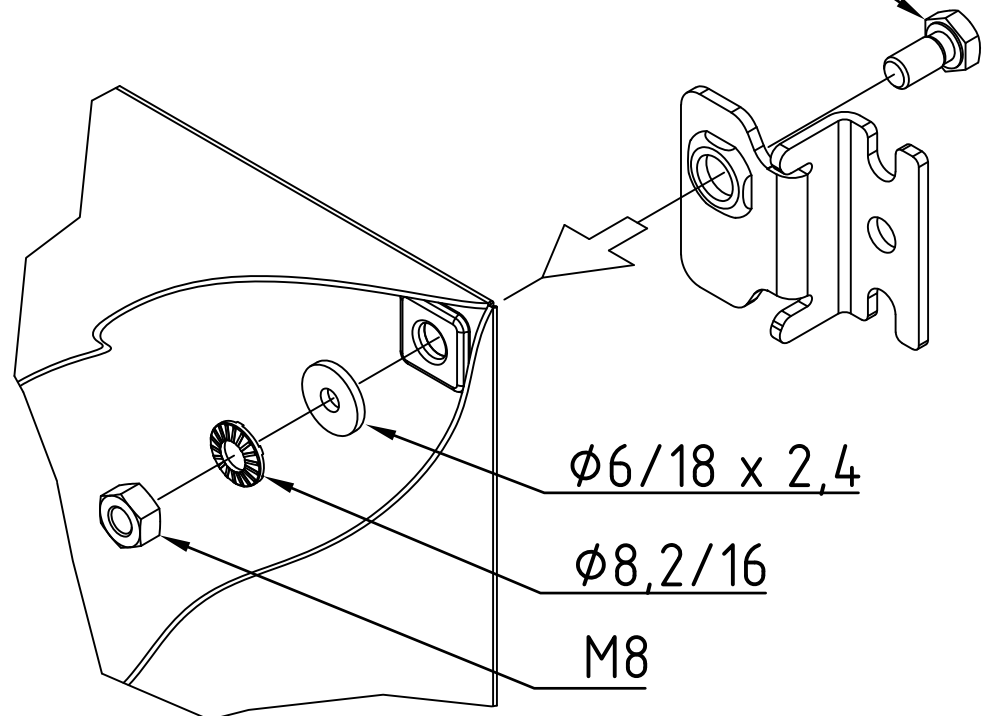

$\phi 6/18 \times 2,4$

$\phi 8,2/16$

M8



